

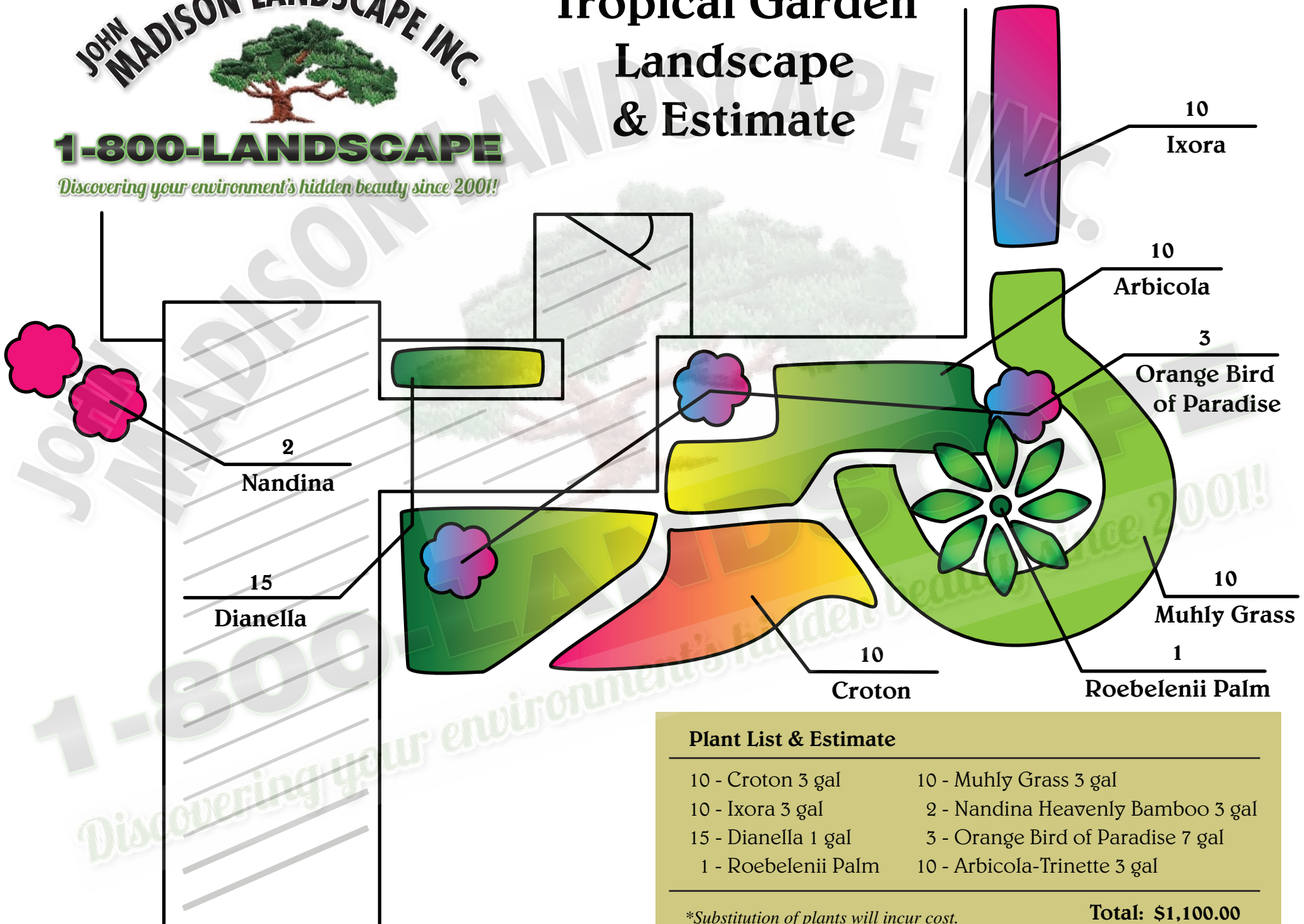

Tropical Garden Landscape & Estimate



Plant List & Estimate	
10 - Croton 3 gal	10 - Muhly Grass 3 gal
10 - Ixora 3 gal	2 - Nandina Heavenly Bamboo 3 gal
15 - Dianella 1 gal	3 - Orange Bird of Paradise 7 gal
1 - Roebelenii Palm	10 - Arbicola-Trinette 3 gal
Total: \$1,100.00	

**Substitution of plants will incur cost.*